

**SITE PLAN LEGEND**

[Symbol]	EXIST. BOUNDARY
[Symbol]	EXIST. STREAM
[Symbol]	EXIST. STREAM BUFFER
[Symbol]	EXIST. WETLAND
[Symbol]	EXIST. RIGHT OF WAY
[Symbol]	EXIST. EASEMENT
[Symbol]	EXIST. BUILDING SETBACK
[Symbol]	EXIST. BUILDING
[Symbol]	EXIST. SIDEWALK
[Symbol]	EXIST. EDGE OF PAVING
[Symbol]	EXIST. CURB & GUTTER
[Symbol]	EXIST. SEWER EASEMENT
[Symbol]	EXIST. FIRE HYDRANT
[Symbol]	EXIST. WATER EASEMENT
[Symbol]	EXIST. OVERHEAD UTILITIES
[Symbol]	EXIST. RETAINING WALL
[Symbol]	NEW PROPERTY LINES
[Symbol]	NEW RIGHT OF WAY
[Symbol]	NEW EASEMENT
[Symbol]	NEW BUILDING
[Symbol]	NEW 24" CURB & GUTTER
[Symbol]	NEW SIDEWALK
[Symbol]	NEW PAVEMENT
[Symbol]	NEW GRAVEL
[Symbol]	NEW LANDSCAPE BUFFER
[Symbol]	NEW SEWER EASEMENT
[Symbol]	NEW WATER EASEMENT
[Symbol]	NEW YARD INLET
[Symbol]	NEW CATCH BASIN
[Symbol]	NEW DROP INLET
[Symbol]	NEW JUNCTION BOX
[Symbol]	NEW OPEN SPACE
[Symbol]	NEW RETAINING WALL

- SITE NOTES**
- TOTAL NUMBER OF UNITS: --- (+1 LOT)
  - TOTAL DENSITY: 14.5 UNITS PER ACRE
  - MINIMUM LOT SIZE PER ZONING: ---
  - OPEN SPACE REQUIRED (15%): 0.30 ACRES
  - OPEN SPACE PROVIDED: 0.58 ACRES
  - 5.1. OPEN SPACE IN STORMWATER AREA: 0.09 ACRES (4.6%)
  - 5.2. OPEN SPACE OVER 25% SLOPE: 0 ACRES (0%)
  - ALL DIMENSIONS ARE FROM EDGE OF ASPHALT, FACE OF WALL, OR FACE OF BUILDING UNLESS OTHERWISE NOTED.
  - ALL WORK SHALL BE IN ACCORDANCE WITH JACKSON COUNTY SPECIFICATIONS AND DETAILS.
  - CUT WALLS WILL BE SOIL NAIL WALLS. FILL WALLS WILL BE BLOCK WALLS.
  - ALL SIDEWALK ALONG BACK OF CURB SHALL BE 6' IN WIDTH MIN. ALL OTHER SIDEWALKS MAY BE INSTALLED AT 5' IN WIDTH.
  - ALL RETAINING WALLS REQUIRE A SEPARATE PERMIT AND SPECIAL INSPECTION.
  - ALL SIGNAGE WILL REQUIRE A SEPARATE PERMIT.
  - SITE LIGHTING TO BE PROVIDED BY DUKE POWER

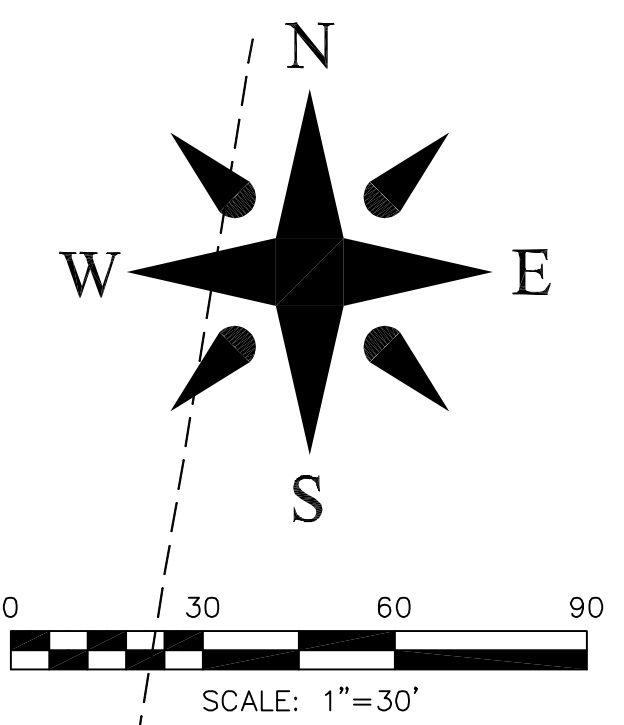
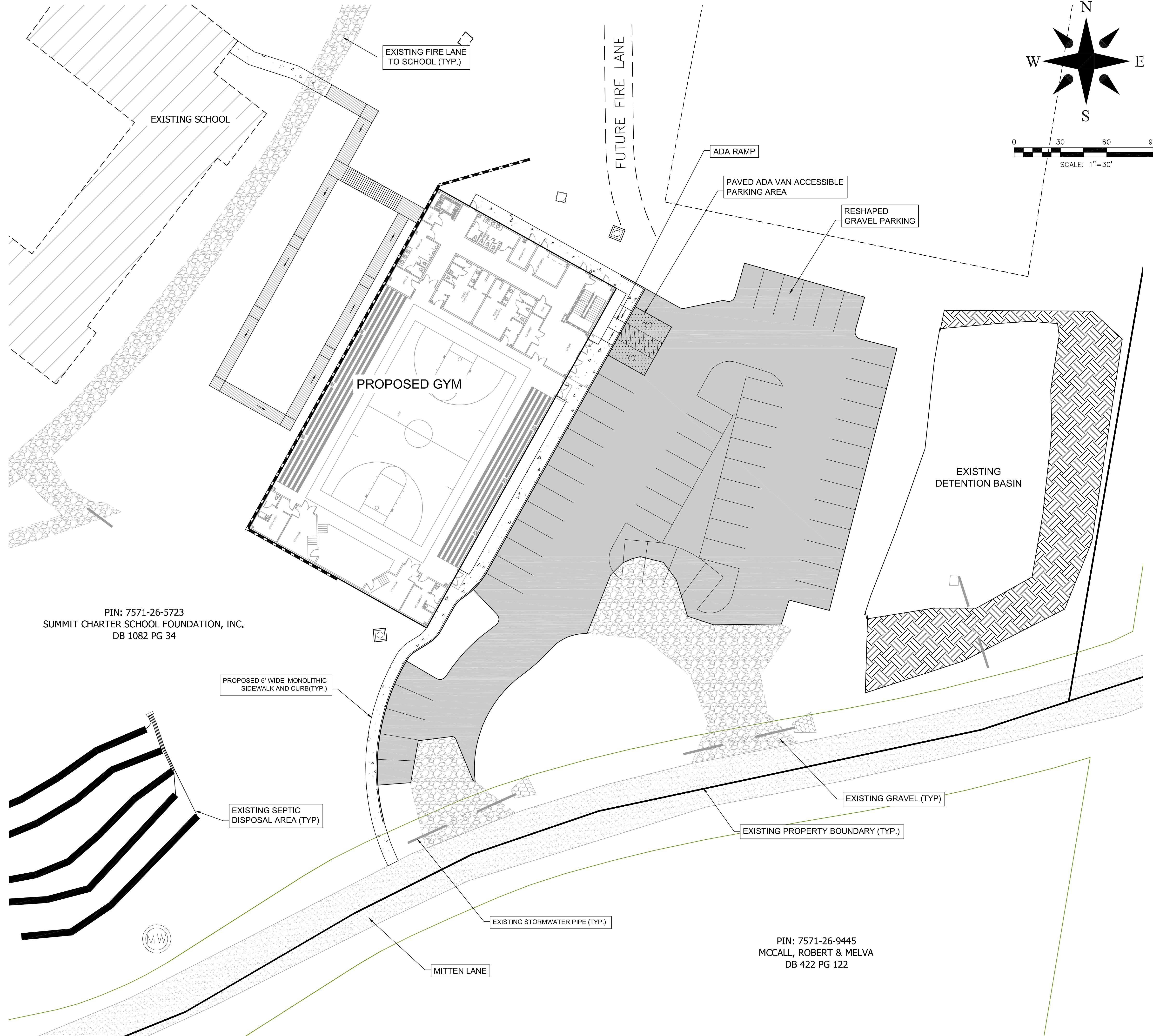

PIN: 7571-26-5723  
 SUMMIT CHARTER SCHOOL FOUNDATION, INC.  
 DB 1082 PG 34

PIN: 7571-26-9445  
 MCCALL, ROBERT & MELVA  
 DB 422 PG 122

Project No: <b>459417</b>	Drawing Title: <b>C-4.0</b>	JACKSON COUNTY NORTH CAROLINA	SUNNIT CHARTER SCHOOL GYM ADDITION	 <b>BROOKS</b> ENGINEERING ASSOCIATES Planning • Engineering • Surveying • Environmental Services •	Designated: TMM Drawn: TMS Checked: TMM	Reviewed: MCB Scale: AS NOTED Date: 11-14-17	17 Arlington Street Asheville, N.C. 28801 Phone: 1-828-232-4700 Fax: 1-828-232-1331 www.brooksea.com	 CONSTRUCTION DOCUMENTS	No.: 1	REVISIONS/SUBMISSIONS CONCEPT SUBMISSION	Date: 11/14/17
					File Location: L:\2017 Projects\459417 Summit_Charter_School_Expansion\Drawings\459417-CIVIL BASE_CLEAN-2.dwg						